



MACWOOD



9/6 ALEXANDER DRIVE,
EDINBURGH



WHAT YOU NEED TO KNOW



1 1 1

Set in the heart of bustling Gorgie and surrounded by retail, dining, and leisure amenities this is a well-presented one-bedroom apartment boasting generous and light-filled accommodation, perfect for a first-time buyer or as an investment.

The front door opens into a spacious hallway adorned with wood-inspired flooring and a soft colour palette. From here you move through to the generous dual aspect dining living room flooded with natural light thanks to twin windows. Featuring a similar décor to the hallway this is a most inviting living and reception space, perfect for relaxation and entertaining. Conveniently adjacent is a sizeable modern kitchen showcasing light oak-effect wall and floor units, a white splashback, smooth grey worktops, and integrated appliances that include a hob and oven. The double bedroom with built-in mirrored wardrobes is light and airy and will accommodate freestanding furnishings. Completing the accommodation is a bathroom with a hidden cistern WC, washbasin built into vanity and a bath with a wall-mounted shower.

Externally, the property benefits from permit parking spaces in a dedicated car park.



OUR EXPERT SAYS...

“Discover convenience and comfort in this vibrant one-bedroom oasis, nestled in bustling Gorgie.”

**- Ross MacDonald,
Director**



468 FT²





FLOORPLAN

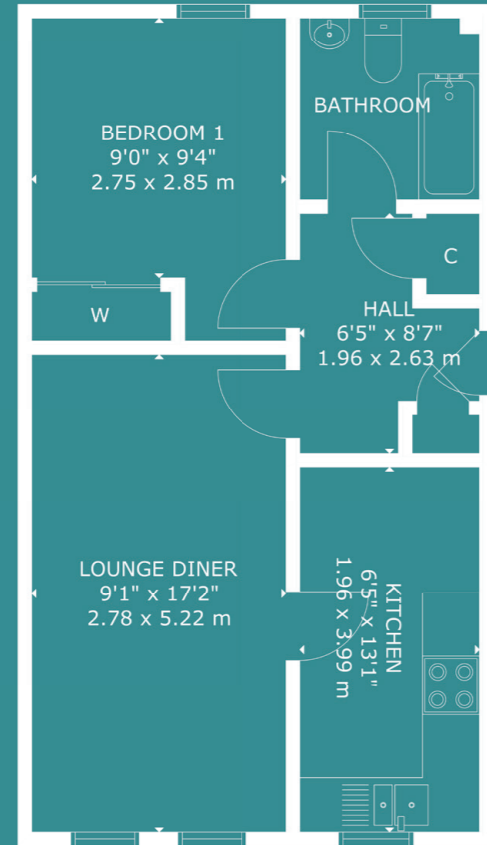

LOCATION

Lying south-west of Edinburgh city centre Gorgie is a vibrant neighbourhood within easy reach of the West End, Financial District, and Haymarket. Close to Corstorphine Hill and Saughton Public Park, residents can enjoy pleasant walks and cycles. Fantastic leisure amenities are on offer at Carrick Knowe Golf Club, Kingsknowe Golf Club, and the Craiglockhart Leisure and Tennis Centre. The nearby O2 Academy, a popular concert and events venue also boasts ten-pin bowling and five-a-side football facilities, and it is an ideal location for Murrayfield Stadium. Bustling Gorgie and Dalry have an array of dining and retail choices and nearby Fountain Park boasts a multiplex cinema, casual eateries, and a state-of-the-art gym. For daily shopping needs, there is a large Sainsbury's, ASDA, and Aldi all in easy reach whilst the Gyle Shopping Centre and Hermiston Gait house well-known supermarkets and high-street stores. Edinburgh Napier University at Merchiston, Edinburgh College Sighthill Campus, and Heriot-Watt University are easily accessible. Regular bus and tram services connect Gorgie quickly to the city centre and beyond, and there is easy access to the A8 linking to the City Bypass.



MACWOOD



**TO REGISTER YOUR
INTEREST, CONTACT:**

4 Redheughs Rigg
Edinburgh
EH12 9DQ

 ross@macwoodproperties.com

 07388 361 564

